

THERMAL
ECONOMICS-
MARKET LEADERS
IN REFLECTIVE INSULATION
MATERIALS

FLOORTHERMTM

THE HIGH PERFORMANCE MICRO-POROUS FLOOR INSULATION MEMBRANE



THE SIMPLE SOLUTION FOR THERMAL INSULATION REQUIREMENTS IN FLOORS

Perforations allow accidental spillage or dampness to dissipate through membrane.

Low emissivity (reflection) achieves high comfort levels at floor and stops draughts from underside of floor.

Self supporting/installed in one application.

TIMBER JOIST FLOORS



PRE-CAST CONCRETE FLOORS



High Insulation levels; U-Value of $0.25W/m^2K$ can be achieved.

Low Cost and simple to install.

Saves the extra brick and blockwork courses.

Eliminates the problems associated with screeding over boards or fibrous quilts.

FLOATING FLOORS



Highly cost effective.

Environmentally friendly. No CFC's etc.

Durability of foil protected by special P.E. coating



Product Applications-

(Please note that all Floortherm applications should be carried out in accordance with the relevant Floortherm Installation Manuals available from our Technical Department.)

Description-Floortherm M.P. is a tough nylon net reinforced polythene membrane laminated on both sides with a low emissive (highly reflective) aluminium foil. The low emissivity of the surface is protected by a special coating. M.P. signifies that the membrane is micro-perforated to facilitate the dissipation of water and gasses.



SUSPENDED TIMBER FLOORS

The Floortherm M.P. membrane is rolled out over the joists and secured in place by means of the proprietary fixing and spacer clips prior to the fixing of the wooden flooring.

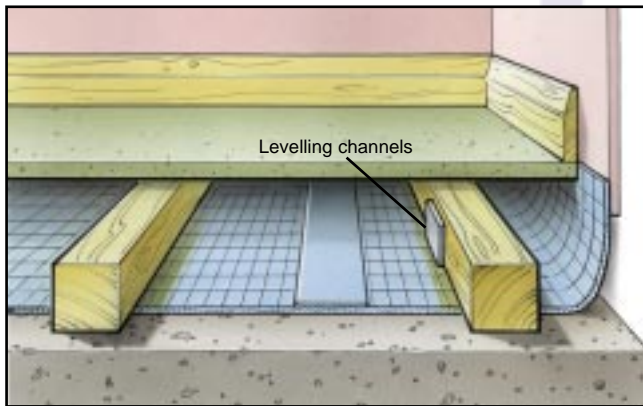

BBA Certificate- All the above described applications have been assessed in BBA Certificate no.97/3375.

Thermal Performance-The improvement of the thermal resistance of the floor achieved by the addition of Floortherm can vary between 1.64m²K/W in the 'precast' and 'suspended timber' floor application to R=1.34m²K/W in the 'timber raft' floor application. The actual U-value of the floor is influenced by the p/a perimeter to area ratio.

Tables of U-value against p/a ratios are provided in the BBA Certificate. Typically, U-values of the order of 0.30 W/m²K can be achieved in housing construction.

Thermal Economics Limited Technical Department will provide U-value calculations on request.



PRECAST CONCRETE FLOORS

The Floortherm M.P. membrane is stretched out over the perimeter wall and secured with the preparatory wire fixing clips prior to the fitting of the d.p.c and placing of the floor elements.

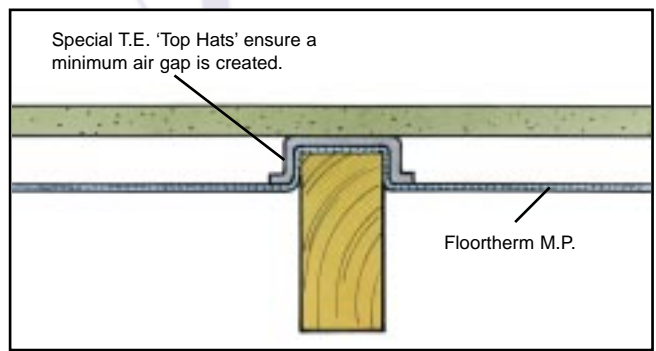

TIMBER RAFT ON CONCRETE FLOORS

The Floortherm S/S membrane is laid out on the concrete floor surface and the timber raft floor and battens (with levelling channels where required) are fitted on top.

Product Data-

Composition-Nylon net reinforced polyethylene laminated with coated low emissive membrane on both sides. The membrane is also micro-perforated.

Standard Roll Sizes-Widths: 990mm and 1500mm.
Lengths: 50m and 100 m.

Fixings-

1. Wire wall clips-for pre-cast floors.
2. 50mm wide plate steel 'top hat' clips-for suspended timber floors.
3. 50mm wide plate steel levelling channels with hardboard shims.

Storage and hazard precautions-

Floortherm is an environmentally friendly and non-hazardous material with a class 1 spread of flame. It should however be protected from open flame or sources of ignition and stored separately from easily ignitable material.



Thermal Economics Ltd
Thermal House
8 Cardiff Road
Luton
Bedfordshire
LU1 1PP