

# TIMBER & RAFTER ROLL 40

## APPLICATION

Timber & Rafter Roll 40 is a resilient, medium density mineral wool roll, designed specifically for thermal, acoustic insulation and fire resistant applications in walls of studded construction in timber-framed buildings. Self supported by friction fitting between timber studs.

### PRODUCT INFORMATION

Thickness	90 & 140 mm
Length & Width	see below
Thermal Conductivity	0.040 W/mK
Product Designation	MW-EN13162-T1
Reaction to fire classification group	A1

### SPECIFICATIONS

THICKNESS (mm)	R-VALUE (m <sup>2</sup> K/W)	LENGTH (m)	WIDTH (mm)	PACK AREA (m <sup>2</sup> )	PRODUCT CODE
90	2.25	9.25	2x570	10.55	3492
140	3.50	6.00	2x570	6.84	3442

### SUITABLE FOR



#### WARM ROOF

See also:  
Timber & Rafter Batt

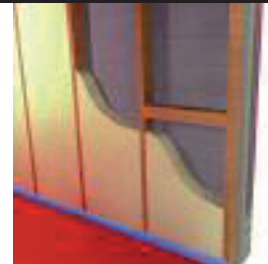

#### EXTERNAL TIMBER FRAME WALLS

See also:  
Timber & Rafter Batt

## ENVIRONMENTAL

Timber & Rafter Roll 40 is produced from fine, non-combustible mineral wool (as defined in BS 3533:1981), bonded with a thermo-setting resin. All Superglass products are made from natural materials and recycled glass. They are CFC and HCFC free, will not rot, degrade or sustain vermin, will not encourage the growth of mould, bacteria or fungi and can be described as being non-hygroscopic.

## HEALTH AND SAFETY

All Superglass products are subject to a Workplace Exposure Limit (WEL) 5 mg/m<sup>3</sup> 8 hour Time Weighted Average Gravimetric Measure. A COSHH sheet (Ref AS001) and Material Safety Data Sheet (Ref AS002) can be obtained from Superglass Technical Department. Further reference can be made to EURISOL's Health & Safety Statement which can be found at [www.eurisol.com](http://www.eurisol.com).



# TIMBER & RAFTER ROLL 40

## BRITISH STANDARDS

Timber & Rafter Roll 40 is manufactured to comply with the requirements of the EU Construction Product Directive (89/106/EEC) and Technical European Harmonised Standards BS EN 13162:2001, BS EN 13172:2001 for Factory Made Mineral Wool Products. Suitable for the conditions in which it is intended.

## FIRE PERFORMANCE

Timber & Rafter Roll 40 is classified as non-combustible with a Reaction to Fire Classification A1 when tested to BS EN 13501-1.

## VAPOUR RESISTANCE

Superglass products possess negligible vapour resistance allowing vapour to pass freely through the insulation.

## TEMPERATURE LIMITATION

Superglass mineral wool has a limiting temperature of 540°C, though with temperatures in excess of 230°C partial loss of the binder may occur at the hot face. This does not impair the thermal performance of the product.

## PACKAGING

Timber & Rafter Roll 40 is supplied compression packed in polythene.

## STORAGE

Superglass products must be stored indoors or under a waterproof covering in order to protect against weather damage.

**For further information, product sheets, alternative dimensions or facings please contact our sales team.**

### Sales Office

E Mail: [sales@superglass.co.uk](mailto:sales@superglass.co.uk)  
Tel: 01786 402014  
Fax: 01786 451245

The office hours are Monday to Friday 8.30am to 5.00pm.

### Technical Support

E Mail: [technical@superglass.co.uk](mailto:technical@superglass.co.uk)  
Tel: 01786 402018  
Fax: 01786 402029

Full product information is also available on CD Rom or can be downloaded from our web site.

### SUPERGLASS CERTIFICATION



### INDUSTRY BODIES



### Superglass Insulation Limited

Thistle Industrial Estate  
Kerse Road Stirling Scotland FK7 7QQ

Tel: 01786 451170  
Fax: 01786 451245

[www.superglass.co.uk](http://www.superglass.co.uk)