

---

# KNAUF SHAFTWALL & FIREFIGHTING SHAFTWALL

A versatile system for forming enclosures around service shafts and lift shafts.

- For enclosure of lift or service shafts.
- Up to 2 hours fire resistance.

A fire and moisture resistant inner lining of Knauf Coreboard allows the shaft enclosure to be constructed prior to the building being weather sealed.

Knauf Coreboard is retained along its entire length in lightweight steel J-channels and C-T studs.

1 or 2 layers of Knauf Fireshield are screw-fixed onto the room side of the framework for shafts to provide the decorative faces. In Firefighting Shaftwall substitute the outer layer with Knauf Fire Moistureshield.

Knauf Fire Moistureshield is used because it is highly durable and is able to withstand the effects of impacts and water, to which it would be subjected during a fire, without losing its fire resistance or integrity. This means that fire crews maintain protected access to all floors within the building.

To allow for floor slab movement, which is a common requirement in multi-storey buildings, a Knauf Deep Flange U-Channel can be used to create a deflection head.

The tapered edges of the Knauf Fireshield and Knauf Fire Moistureshield boards can be taped and jointed to provide a seamless finish, or skim plastered for a more traditional plaster finish.

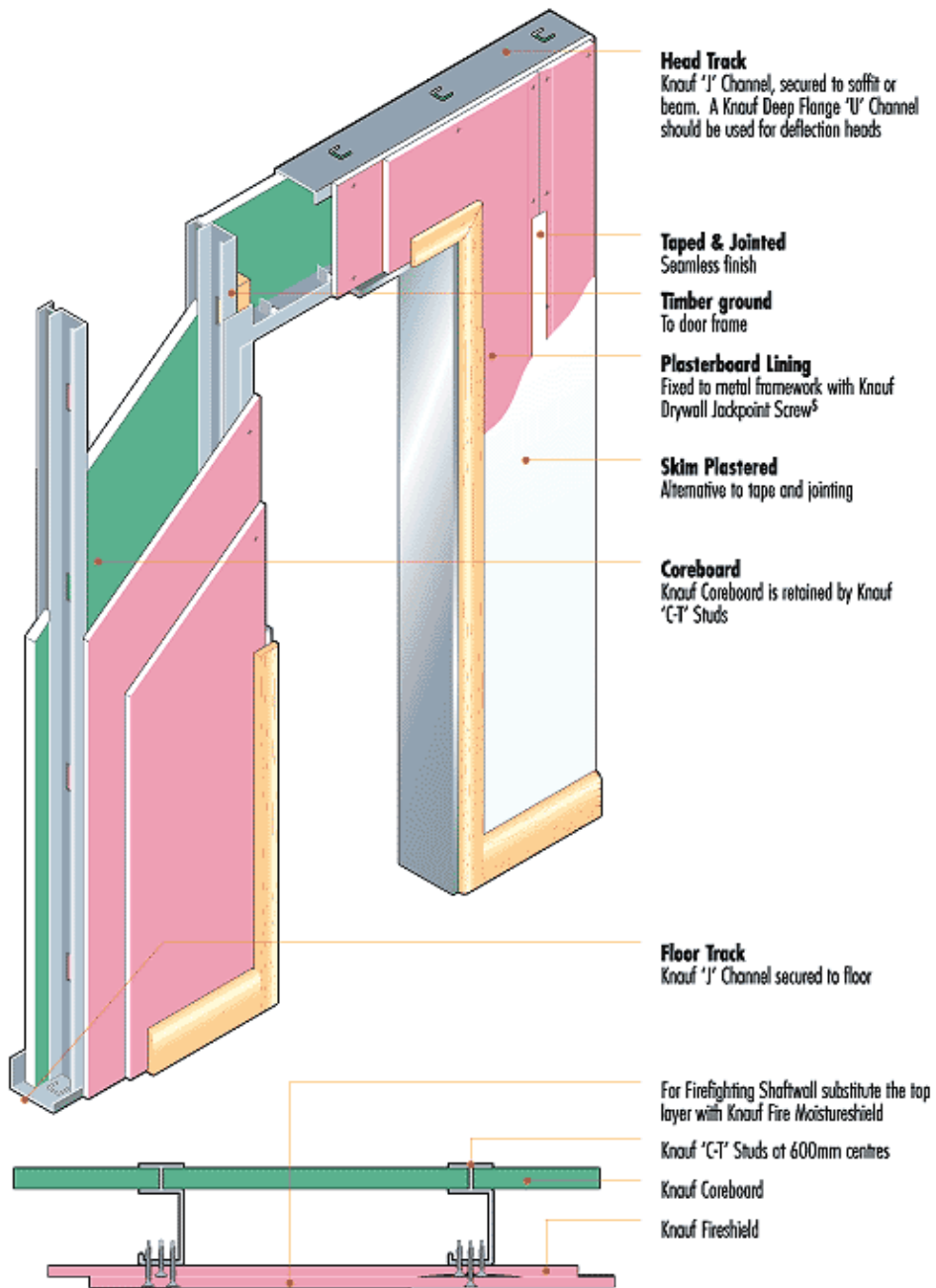

---

## Metal Components



### **Knauf C-T Stud**

Galvanised steel sections used to form the vertical frame.

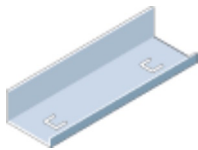

### **Knauf J Channel**

Galvanised steel sections used to form the perimeter frame. Bent out tabs are used to retain the board.

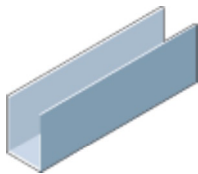

### **Knauf Deep Flange U Channel**

Alternative deep channel used to form the head to allow for slab movement.

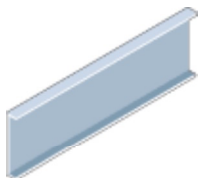

### **Knauf Fixed Channel or Flat Plate**

Shallow channel used to provide backing for horizontal joints in facings and to provide fixing points for medium load fixtures.

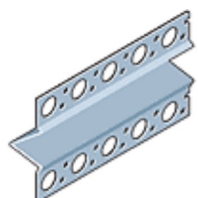

### **Knauf Movement Control Joint**

Galvanised steel 'V' section used to bridge gaps left for expansion and contraction in drywall partitions.

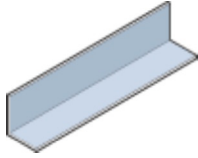

### **Knauf Angle Sections**

Knauf Angle Sections are used to retain mineral wool packing in deflection head details.

## **Key Drywall Accessories**



### **Knauf Sealant**

Should be used to seal gaps against airborne transmission of sound and vibration.



### **Knauf Jointing Compounds**

A range of air drying and fast setting jointing compounds are available to achieve a seamless finish.



### **Knauf Skimming Plasters**

Knauf MultiCover, Knauf Universal Board Finish and Knauf Pro Board Finish can be used to skim the boards.