

RICHTER SYSTEM

WALL LINING SYSTEM (RLS)

pack pallet

RLS Channel suspension system for Plasterboards

Concealed galvanised steel suspension system for lining of walls and Beams, finished with plasterboards. Located with Head and Floor tracks and fixed to background with adjustable U brackets. System is quick to install with flexible depth of suspension offering minimum depth of suspension whilst being able to accommodate any insulation material. Star connector offers easy installation were transverse bracing is required.

RLS 1 Channel section.

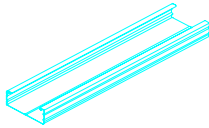

45x18x06 x 2400 to 4000mm 10 400
Main board carrier section. Spacings are depending on panel thickness and weight. Boards are fixed with standard drywall screws.

RLS 8 U Track section.

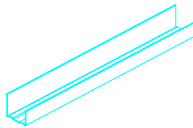

30x20x27x06 x 3000 or 3600mm 10 400
Fixed to floor and ceiling to locate RLS 1. Fixed at 600mm centres.

RLS3 C Connector

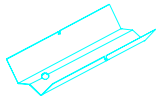

100x45mm 50
Used to join RLS1 channel sections.

RLS2 U bracket

RLS 9 U bracket

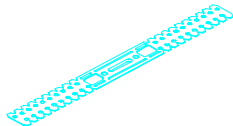

195x30mm. Maximum void 60mm 100
295x30mm. Maximum void 125mm 100
Fixing bracket to locate RLS1 channel to background.
Use metal anchor for fixing to background and panhead screw for location with RLS1 Channel section.

RLS 92 Star connector

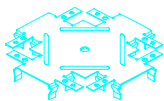

135x135mm 50
Junction connector for fixing of transverse noggins.
Also used for direct fixing to background.

RLS 10 Direct Fixing Clip



Beam fixing clip. 100
Minimum void when fixing to I beams.

Drywall section manufactured to BS7364:1990