

# NOVIA DO 103/195 Monolithic Breather

Permeable roof underlay for use directly onto insulation or boarding.

NOVIA

Novia Ltd

Unit 12 Heronden Road  
Park Wood Industrial Estate  
Maidstone, Kent. ME15 9YR

**Novia DO 103/195** is a high performance monolithic roof-underlay with excellent water vapour transmission characteristics, and superb water resistance. Designed for direct installation over insulation, boarded roofs or rafters. Suitable for all pitched cold and warm roofs.

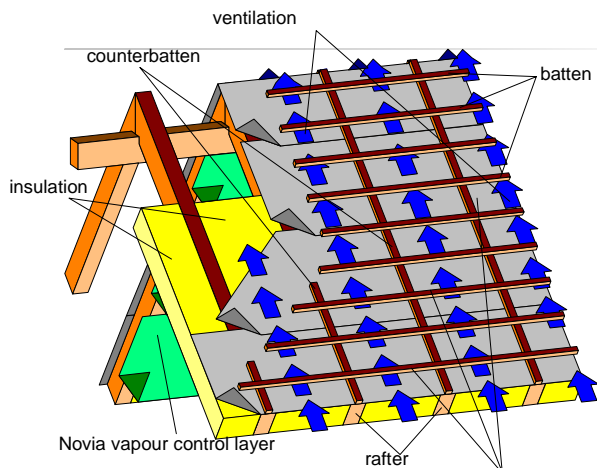

**Novia DO 103/195**  
Breathable roof underlay

## Composition:

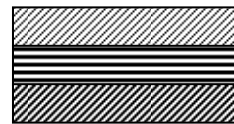

PP - non woven black UV  
permeable membrane  
PP - non woven black UV

## Size:

Standard width	1.5	m
Roll length	50	m
Roll weight	15	kg
Packing unit	24	rolls per pallet

- ✓ **Water resistant monolithic membrane (no holes to clog)**
- ✓ **High breathability**
- ✓ **Flame and UV - resistant**
- ✓ **Low weight, high tear and nail tear strength, matt finish slip-resistant surface**
- ✓ **Simple handling and easy to use**
- ✓ **Easy to recycle**

## Technical data:

			Test method
Weight:	~ 195	g/m <sup>2</sup>	EN 1849-2
Tensile strength:	~ 340/280	N/50mm	EN 12311-1
Elongation:	~ 50	%	EN 12311-1
Tear resistance:	~ 300	N	EN 12310-1
Water vapour transmission rate:	~ 260 +/- 40	g/m <sup>2</sup> d	ASTM F-1249-90
Sd-value:	~ 0,15	m	
Resistance to water penetration:	> 400	hPa	EN 13111
Flame resistance:	B2		DIN 4102
Temperature resistance:	-40 to +80	°C	
UV - resistance:	3	month	

Highly breathable monolithic roof underlay for use directly over insulation

# Novia DO 103/195

## Installation instructions:

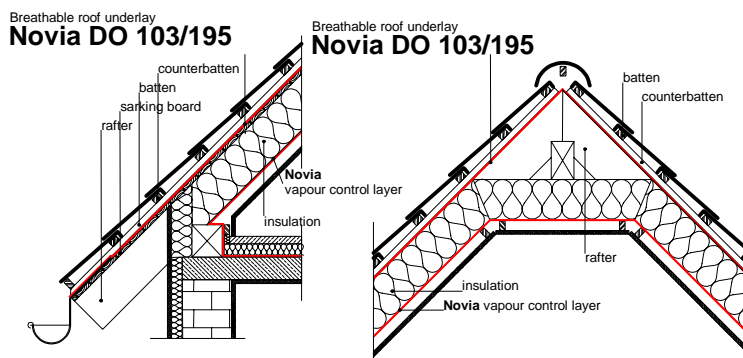

- Handle material carefully to prevent tears and punctures. Repair any damage which does occur with adhesive tape.
- Lay **Novia DO 103/195** starting at the eaves horizontally across the rafters, with a horizontal overlap of 100 to 150 mm (pre-printed overlap), if the slope is greater than 25°. Use a 200 mm overlap if the slope is less than 25°.
- On insulated warm roofs **Novia DO 103/195** can be placed directly on to the insulation and also on boarded roofs.  
**Novia DO 103/195** can also be used in conventional cold roof applications.
- The membrane should be overlapped 200 mm on each side of the ridge.
- All vertical overlaps must be situated on a rafter and must be sealed.
- Temporarily fix **Novia DO 103/195** in place directly onto the rafters. Then permanently fix **Novia DO 103/195** to rafters through counter-battens (laid above the rafters).
- Seal any nail damage as necessary. **Novia DO 103/195** is UV resistant and can be exposed on site for a period not exceeding 3 months.
- At any entry points for services (soil pipes, vents etc.) ensure that **Novia DO 103/195** is properly sealed.
- Where pipes etc. penetrate the underlay cut neatly and accurately and turn edges up to give a tight water-resistant fit.
- Ensure that for warm roof applications, a vapour barrier is installed beneath the insulation.
- Ensure that sufficient ventilation is incorporated to comply with building regulations and technical standards.

**Novia DO 103/195** will reduce the risk of condensation within the roof space but in certain atmospheric conditions it can never be totally eliminated.