

## MF

The Knauf MF Ceiling System can accept some degree of loading and is the more traditional form of application.

This system can utilise one or more layers of a wide range of boards, Knauf Wallboard, Knauf Moistureshield, Knauf Soundshield, Knauf Vapourshield, Knauf Fireshield, Knauf Fire Moistureshield and Knauf Denseshield, depending on the performance required. The boards are fixed onto a lightweight metal framework of Knauf MF Ceiling Channels MF Support Primary Channels and Knauf MF Perimeter Channels.

The lightweight galvanised grid is suspended by either strap hangers or angle sections fixed to the structural soffit with soffit cleats.

The tapered edge boards can be taped and jointed using Knauf Jointing Compounds and Accessories. Alternatively, a 2 to 5mm skim coat of Knauf MultiCover or Knauf Universal Board Finish can be applied to achieve a more traditional plaster finish.

**Cavity fire barrier**  
May be required in ceiling voids to meet building regulations. Where the partition below is designed to be fire resistant, a firebreak in the void above is likely to be required unless the ceiling itself can provide adequate fire resistance.

**Movement control joints**  
Should be provided in large areas and where movement is likely to occur.

**Knauf plasterboard ceiling**  
One or more layers of Knauf plasterboard are screw-fixed to the Knauf MF Ceiling Channel from below.

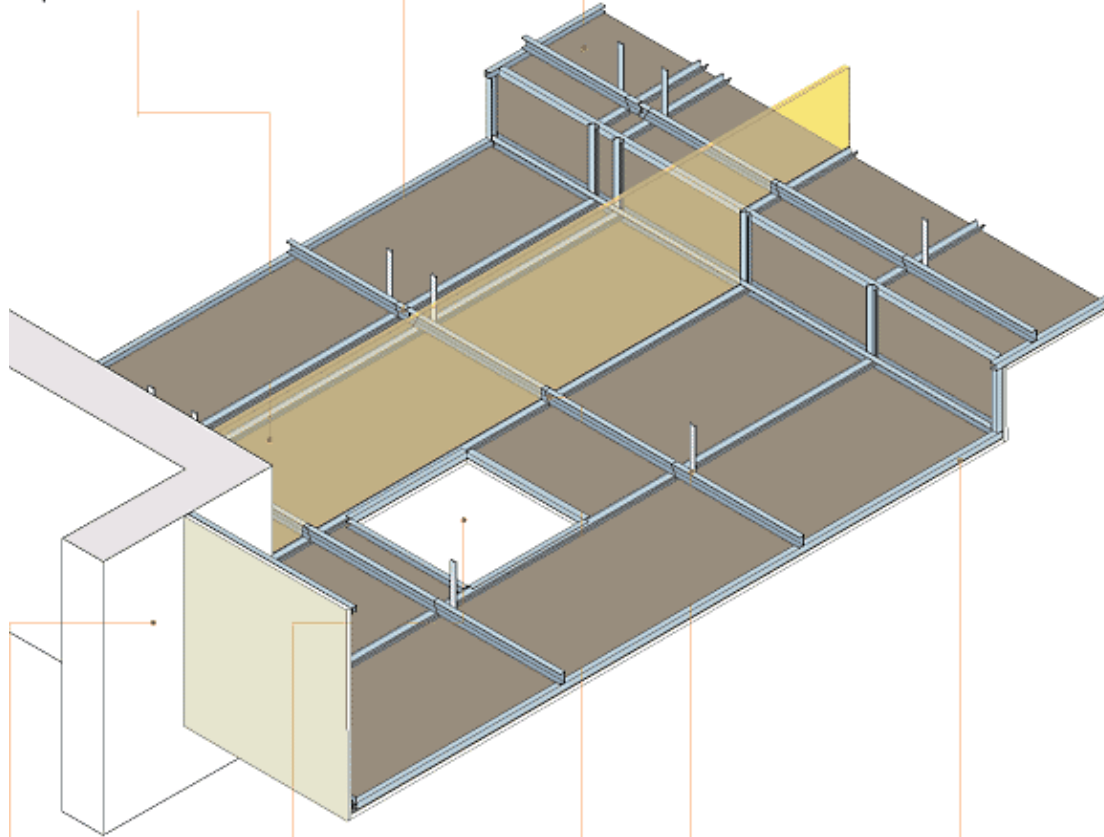

**Bulkheads**  
The forming of bulkheads is built up from Knauf MF components.

**Access panels**  
Framing is formed using perimeter channel fixed to the ceiling channels.

**Strap Hangers and Primary Support Channels**  
Strap Hangers are screwed to the Primary Support Channels.

**Connecting clips**  
Are used to connect the MF Primary Support Channels and MF Ceiling Channels forming the MF support grid.

**Perimeter channels**  
Provide support at the edges of the ceiling. These are screw-fixed to perimeter walls at the level of the MF Ceiling Channels.