

AIM Horizontal Closer

December 2003

Horizontal Acoustic Cavity Closer to Part E, with 2 hour fire rating to BS 476 Part 20.

AIM Horizontal Closers comply with Approved Document E 2003 to the Building Regulations 2000.

AIM Horizontal Closers provide a fire resistance performance of 2 hours insulation and integrity in terms of BS 476 Part 20

The mineral wool is non-combustible in accordance with BS476 part 4 (1970). The DPC conforms to BS6515 (1984).

The Closer conforms with the 1994 Building Regulations and the National House Building Council Requirements.

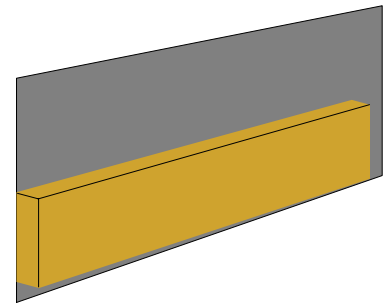

AIM semi-rigid mineral wool to polyethylene DPC Cavity Closer.

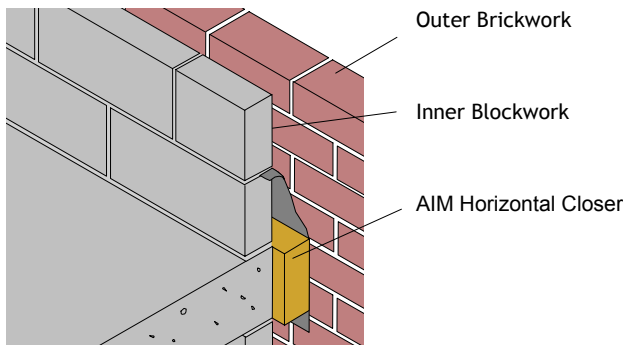

The AIM Horizontal Closer has been designed to provide resistance to the passage of flanking sound through the wall cavity adjacent to separating floors, and complies with the requirements of Part E.

The AIM Horizontal Closer will also provide at least 2 hours resistance to the spread of fire past the separating floor.

The specialist medium density mineral wool insulation used for the horizontal closer, is pre-compressed to enable it to take up any minor irregularity in the wall void. This procedure also makes the insulation more flexible and easier to handle.

Dimensions

Standard sizes below. Other sizes are available to special order.

AIM HORIZONTAL CLOSER	
Mineral Wool Insulation	DPC—Polyethylene
Length: 1200mm	Length: 1300mm
Width: 260mm	Width: 600mm
Thickness: 50, 65, 75, 90, 100mm	Overlaps: Top 300mm Bottom 40mm

Other AIM Cavity Closers

- AIM Cavity Closers**
 to close openings in cavity walls at door and window frames.
- AIM Party Wall Fire Closers**
 to vertically close cavity walls, where a party wall meets the outside cavity wall. Party Wall Fire Closers provide acoustic and fire resistance

AIM Horizontal Closers

Fixing Details

The AIM Horizontal Closer should be installed in the external cavity wall at the level of the separating floor. The closer is installed with the wide dpc overlap uppermost, as indicated in the illustrations with the dpc embedded into the inner blockwork in the mortar layer above the closer, so as to form a cavity tray.

If being used as a fire closer the product must be positioned immediately above a row of metal wall ties. If this is not possible the Horizontal Closer can be supplied with fixing clips. These are embedded into the mortar joint above floor level and the Horizontal Closer is impaled onto the clips

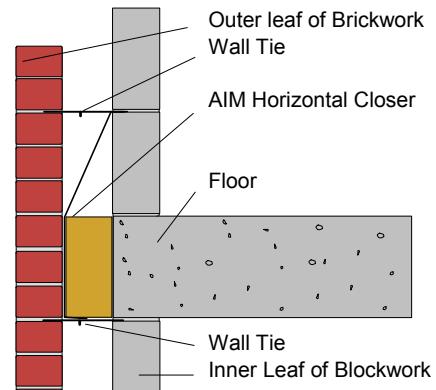

Dimensions

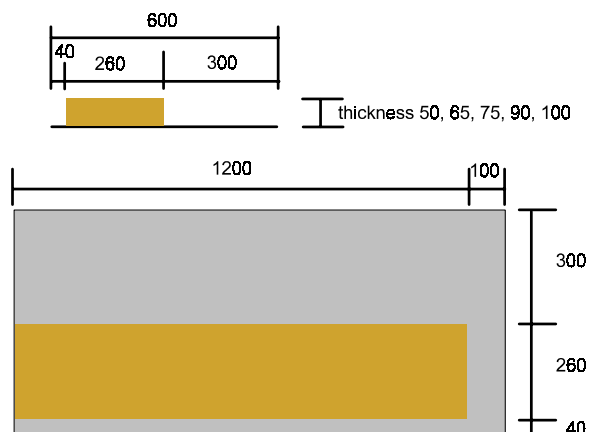

Fire Resistance

The performance of the AIM fire protection range has been tested to BS 476 part 20 and assessed by Warrington Fire Research Centre. The AIM Horizontal Closer will provide a fire rating of 2 hours. AIM mineral wool products are incombustible to BS 476 part 4, rated Class 1 Surface Spread of Flame to BS 476 part 7 and comply with the performance requirements of Class O of the Building Regulations (does not apply to the DPC).

Handling & Storage

AIM rock wool products are easy to handle, but should be treated with relative care to ensure their integrity and shape is maintained. They should be stored in fairly dry conditions. Should indoor storage be impossible the product should be stacked clear of the ground and covered with a stout tarpaulin.

Composition & Durability

AIM rock wool products are chemically inert, will not sustain vermin and do not encourage the growth of rot, fungi, moulds or bacteria. They are compatible with all normal building materials. They do not degrade under normal conditions found in buildings, and will perform effectively for the life of the building.

AIM Limited

Comforts Place Farm, Tandridge Lane
Lingfield, Surrey, RH7 6LW
Tel: 01342 893 381
Fax: 01342 892 453
email: sales@aimlimited.co.uk
web: aimlimited.co.uk