

ON
BOARD

Tileboard



Tile backer board

A high performance tile backing building board that's impervious to water damage, rot, fungi, insect and vermin, Tileboard is the ideal substrate for interior tiled areas that are likely to be affected by moisture.

Tileboard combines its moisture resistance with Class 0 fire performance, excellent impact resistance and dimensional stability. Easy to handle and work, the boards can be fixed using standard tools to a variety of timber or metal fixing systems.

It is complemented by Eterstrip and Eterfiller for seamless jointing.

Recommended applications

Bathrooms, shower and changing rooms, kitchens, basements, sanitary areas, classrooms and swimming pools.

Dimensions

Thickness (mm)	6	9	12
Dimension (mm)	1200 x 2500	600 x 2500	1200 x 2500
	-	1200 x 2500	-
	-	1200 x 3000	-
Weight (kg/m ²)	8.1	12.7	17

Cutting options

Stationary saw or hand circular saw (with rail) - on slow rotation with carbide-tipped teeth or fast rotation with diamond cutting blade without teeth.

Jigsaw with carbide-tipped tooth cutting blade.

Edge finish options

Moulding cutter, fine emery cloth, sanding block or carbide-tipped plane.

Drilling

Holes. Carbide or carbide-tipped twist drill with 60° nose angle.

Sound apertures. Carbide-tipped cup drill or circular cutter, supporting the sheet around the hole with e.g. a wooden surface.

Note: Cutting and drilling must take place in a dry environment. For decorative applications, all sawdust and shavings must be immediately removed from the sheet with a dry micro-fibre towel to prevent permanent staining.

Fastening accessory options

Stainless, galvanised or phosphated steel should be chosen, depending upon the application. See application instructions for more information.

Screwing

Screws with countersunk torx head and full thread can be screwed directly without pre-drilling.

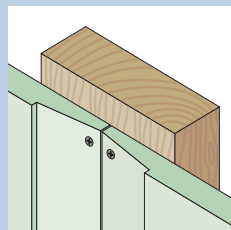

Screw fix to timber battens within bevelled area

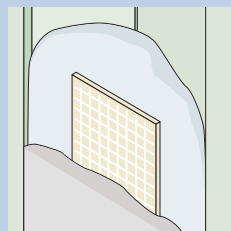

Eterfiller and Eterstrip providing a seamless joint

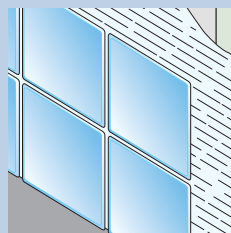

Complete by tiling the area



Nailing and stapling

Pneumatic or hand nailing with flat head nails does not require pre-drilling. Do not drive nails or staples too deeply into the sheet. Pneumatic nails should be regulated to a constant depth.

Smoothing the joints

Bevelled edges should be partly filled with Eterfiller, with an Eterstrip gauze ribbon embedded in it while wet, then more Eterfiller used to fill up the bevelled edge. Allow to dry for one day before tiling.

Non-tiled areas

Non-tiled areas other than splash zones can be finished with paint, render or wallpaper or other decorative systems compatible with the board. For a high level of finish, textured coatings, render or textured wallpaper are advised.

In non-bevelled areas fixings should be countersunk – best achieved by fixing the board with screws and countersinking the board with a mill, then sanding locally at the fixing positions and creating a smooth finish with Eterfiller. Once dried, lightly sand the joint to a flat surface before the final finish.



Class 0



Impact resistant



Easily worked and decorated



Moisture resistant

Handling and storage tips

When panels are supplied with protective paper or plastic between the faces, this should not be removed.

Always lift panels off each other. Never slide them off, as this can cause scratching.

When carrying panels, start by standing them on the back edge and lift with one person at each end. Protect the face from scratching or damage and always lean panels towards the back edge to avoid damaging the visible front edge.

Edge damage can be prevented by having a carpet-covered pallet on site.

Any moisture allowed to penetrate between the stored sheets can cause permanent surface staining. Avoid this by storing all Marley Eternit high performance boards flat on pallets, in dry conditions indoors and undercover. Protect them from the weather and other trades at all times.

Health and safety

Dust can be released while the sheets are being processed which can irritate airways and eyes. It is recommended that a dust mask and safety goggles be worn.

Appropriate dust extraction or proper ventilation are to be provided. Long-term exposure to dust can be harmful to health.

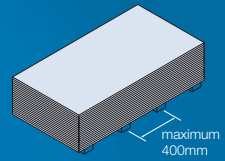

Stack on a level surface

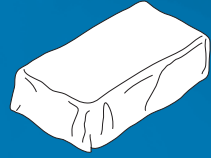

Store under cover

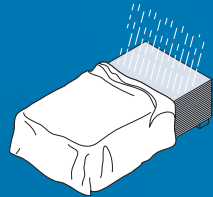

Must be protected from the weather

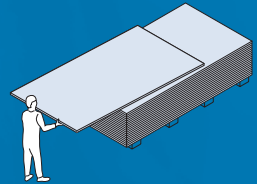

Do **not** drag sheets off the stack

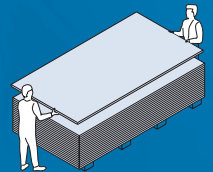

Must lift the sheets off the stack

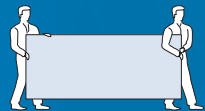

Carry on edge but do not store on edge