

NOVIA DO 93/135 Reflex

Permeable roof underlay for use directly onto insulation or boarding.

NOVIA

Novia Ltd

Unit 12 Heronden Road
Park Wood Industrial Estate
Maidstone, Kent. ME15 9YR

NOVIA DO 93/135 Reflex is a reflective metallic-faced breather membrane. This low weight, high performance building membrane is suitable as a breathable roof or wall underlay. It has excellent water resistance and is suitable for direct installation over insulation, boarded roofs or rafters. Suitable for all pitched cold and warm roofs.

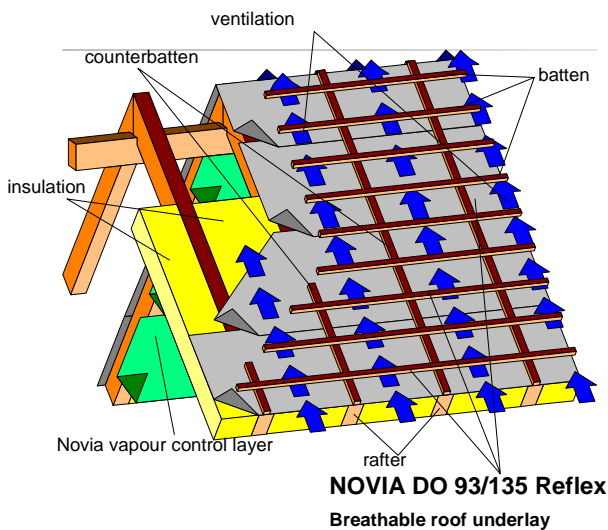

- ✓ **3-layer laminate with low emissivity and high reflectivity**
- ✓ **Breathable membrane with excellent waterproofing properties**
- ✓ **High breathability**
- ✓ **Flame and UV resistant**
- ✓ **Low weight, high tear and nail tear strength, matt finish slip-resistant surface**
- ✓ **Simple handling and easy to use**
- ✓ **Easy to recycle**

Composition:

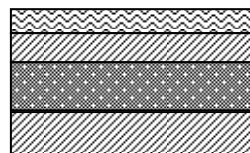

metallised PP - non woven
PP - breathable film
PP - non woven

Size:

Standard width	1.5	m
Roll length	50	m
Roll weight	10	kg
Packing unit	50	rolls per pallet

Technical data:

			Test method
Weight:	~ 135	g/m ²	EN 1849-2
Tensile strength:	~ 220/170	N/50mm	EN 12311-1
Elongation:	~ 45/85	%	EN 12311-1
Tear resistance:	~ 230/280	N	EN 12310-1
Water vapour transmission rate:	~ 600 +/- 200	g/m ² d	ASTM F-1249-90
Sd-value:	~ 0,05	m	
Resistance to water penetration:	> 250	hPa	EN 13111
reflectivity	66	%	internal
Flame resistance:	B2 (E)		DIN 4102
Temperature resistance:	-40 to +80	°C	
UV - resistance:	2	month	

Highly breathable roof underlay for use directly over insulation

Novia DO 93/135

Installation instructions:

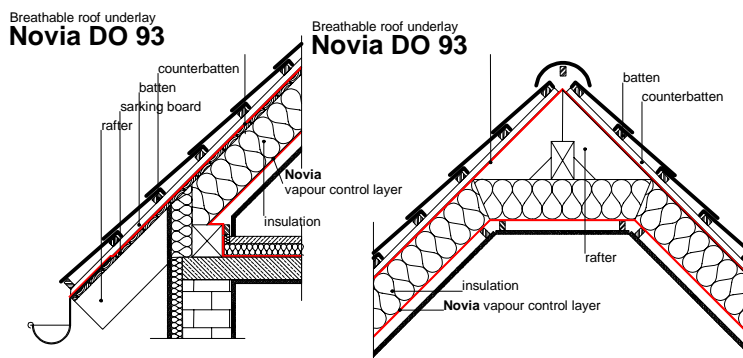

- Handle material carefully to prevent tears and punctures. Repair any damage which does occur with adhesive tape.
 - Lay **Novia DO 93/135** starting at the eaves horizontally across the rafters, with a horizontal overlap of 100 to 150 mm (pre-printed overlap), if the slope is greater than 25°. Use a 200 mm overlap if the slope is less than 25°.
 - On insulated warm roofs **Novia DO 93/135** can be placed directly on to the insulation and also on boarded roofs.
Novia DO 93/135 can also be used in conventional cold roof applications.
 - The membrane should be overlapped 200 mm on each side of the ridge.
 - All vertical overlaps must be situated on a rafter and must be sealed.
 - Temporarily fix **Novia DO 93/135** in place directly onto the rafters. Then permanently fix **Novia DO 93/135** to rafters through counter-battens (laid above the rafters).
 - Seal any nail damage as necessary. **Novia DO 93/135** is UV resistant and can be exposed on site for a period not exceeding 2 months.
 - At any entry points for services (soil pipes, vents etc.) ensure that **Novia DO 93/135** is properly sealed.
 - Where pipes etc. penetrate the underlay cut neatly and accurately and turn edges up to give a tight water-resistant fit.
 - Ensure that for warm roof applications, a vapour barrier is installed beneath the insulation.
 - Ensure that sufficient ventilation is incorporated to comply with building regulations and technical standards.
- Novia DO 93/135** will reduce the risk of condensation within the roof space but in certain atmospheric conditions it can never be totally eliminated.